

INON

Quick Shoe W50 Clamp

Package contents:

- W50 Clamp Body ① ×1
- M6x10 Cap Screw ② ×2
- Allen Wrench 2mm ③ ×1
- Allen Wrench 5mm ④ ×1
- This user manual ×1

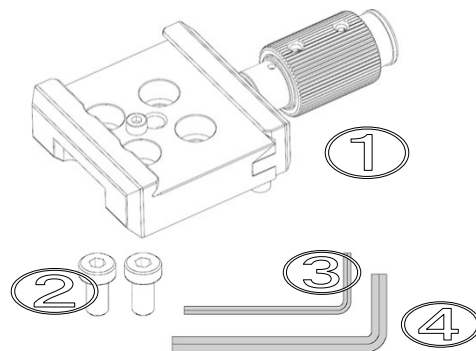

Overview:

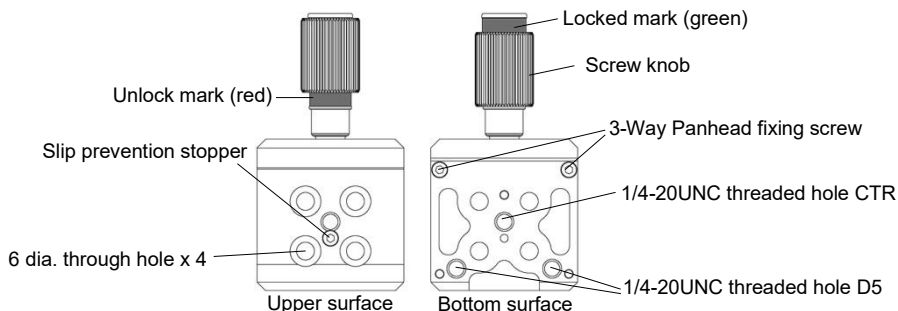

Compatible products

[Quick Shoe]:

- Quick Shoe W50 Plate, Quick Shoe W27 Plate, Quick Shoe W95 Plate
- Quick Shoe L-Type Bracket

Note: Other brands' Arca-Swiss plate is **not** compatible with this product

[Arm Base]:

- Grip Base D5, UW 3-Way Panhead, UW Tripod Hub, Shoe Base 1/4-20UNC

[Arm System]:

- D5 Holder, D Holder, Holder III

Installation

Quick Shoe Plate:

- Slowly turn the screw knob counterclockwise to unlock until **red unlock mark** is exposed. Turning the **screw knob** clockwise locks the clamp where **green locked mark** is exposed.

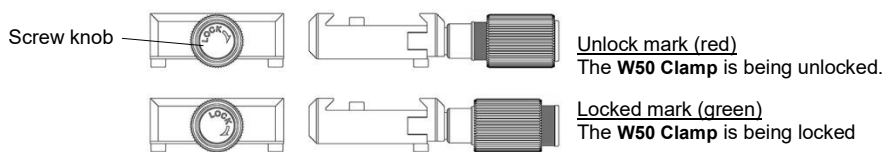

- Securely attach combined **Quick Shoe Plate** on the **W50 Clamp Body** by engaging their dovetails one by one as per below illustration. Once dovetails have been securely engaged, keep turning the **screw knob** clockwise until the **locked mark (green)** is displayed.

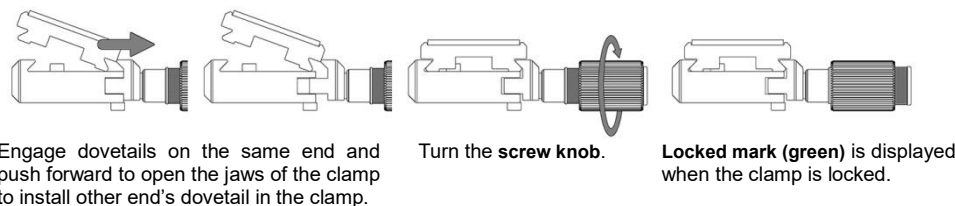

- Make sure to completely tighten the **screw knob** to securely lock the clamp to prevent the **Quick Shoe Plate** from accidentally sliding out of the clamp resulting in damage of combined product or personal injury.

Installation**Grip Base D5:**

- Remove **3-Way Panhead fixing screws** from the **W50 Clamp Body** by supplied **Allen Wrench 2 mm**.
- Screw the **1/4 Tripod Screw (L13.6)** of the **Grip Base D5** into the **1/4-20UNC threaded hole D5** on the bottom surface of the **W50 Clamp Body**.

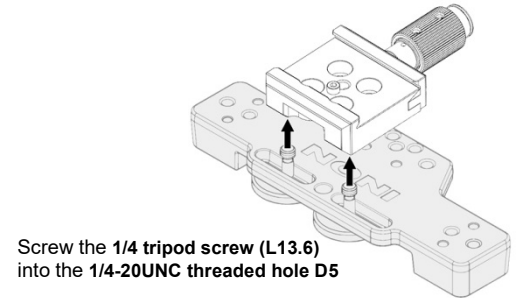
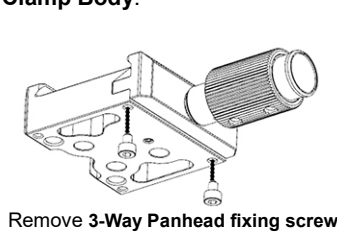
**UW 3-Way Panhead:**

- Screw the **Tripod Screw (1/4 in)** of the **UW 3-Way Panhead** into the **1/4-20UNC threaded hole CTR** on the bottom surface of the **W50 Clamp Body**.
- Adjust the **Camera Plate** position so that its convex edge contacts **3-Way Panhead fixing screws** of the **W50 Clamp Body** to avoid accidental loose of the **tripod screw (1/4 in)** and rattle of the **Quick Shoe W50 Clamp** then tighten the **tripod screw (1/4 in)** completely.

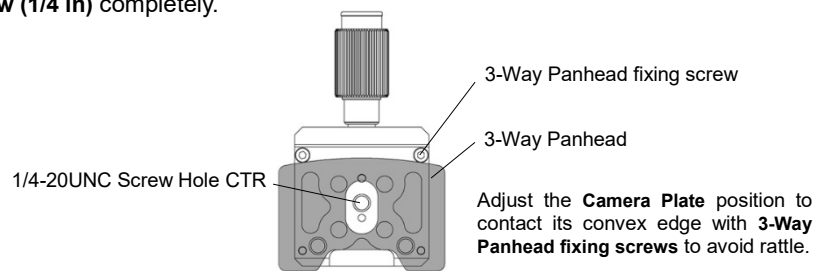
**UW Tripod Hub:
Shoe Base 1/4-20UNC**

- Screw the **tripod screw (1/4 in)** of the respective product into the **1/4-20UNC screw hole CTR** on the bottom surface of the **W50 Clamp Body** to fasten two components.

**D5 Holder:
D Holder
Holder III**

- Match **M6 screw holes** on the top edge of the respective handle to **6 dia. through holes** and fasten with supplied two **M6x10 Cap Screws** by tightening them with supplied **Allen Wrench 5 mm**.

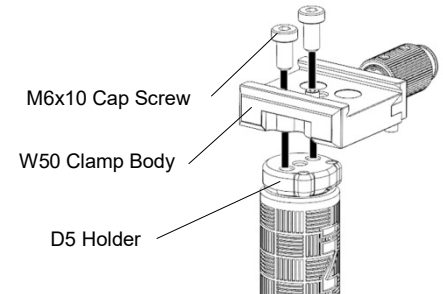
**Maintenance:**

- After using, soak in fresh water to dissolve remaining salt/remove dirt and dry it in shaded and well ventilated area. Never apply flame or direct heat to this product or damage may result.
- DO NOT** clean with organic solvent like alcohol, benzene or thinner and oil and fat containing/chemical material like rust inhibitor, lubricant, polish, detergent (especially alkaline detergent) to avoid damage/deformation/degradation of this product.
- Periodically apply grease on metal part of screws to prevent them from rusting.

Storage:

- After completely dry, store out of direct sunlight in well-ventilated, dry area. Avoid storing near chemicals, high ozone, large temperature and humidity fluctuations to avoid deformation, damage, rust, mold or corrosion etc.
- Keep the product out of reach of children. They may swallow parts of this product. See a doctor immediately if a child swallow parts.

Handling:

- Make sure to follow installation procedures described in this manual. Insufficient tightening of the **screw knob** may lead to accidental separation/damage/loss of combined products and/or damage.
- DO NOT** use this product for non-compatible products to avoid accidental separation/damage/loss of combined products. Use only with compatible products listed in this user manual.
- Securely hold this product/combined products during transportation of whole system without applying excessive shock, vibration and/or pressure. **DO NOT** hold compatible products only to transport whole system to avoid accidental separation/damage/loss of combined housing/products.

INON INC. 2-18-9, Dai, Kamakura, Kanagawa 247-0061 JAPAN
E-mail support@inon.co.jp, Fax +81(0)467-48-2178
URL <http://www.inon.jp/>

As of September 2020