

# INON

## INON ZD Front Mask for Ace Pro

Thank you for purchasing INON product.

The INON “ZD Front Mask for Ace Pro” is a multi-purpose product to attach INON ZD Mount lens, arm etc. on Insta360 Dive Case

### Package, Name of Parts

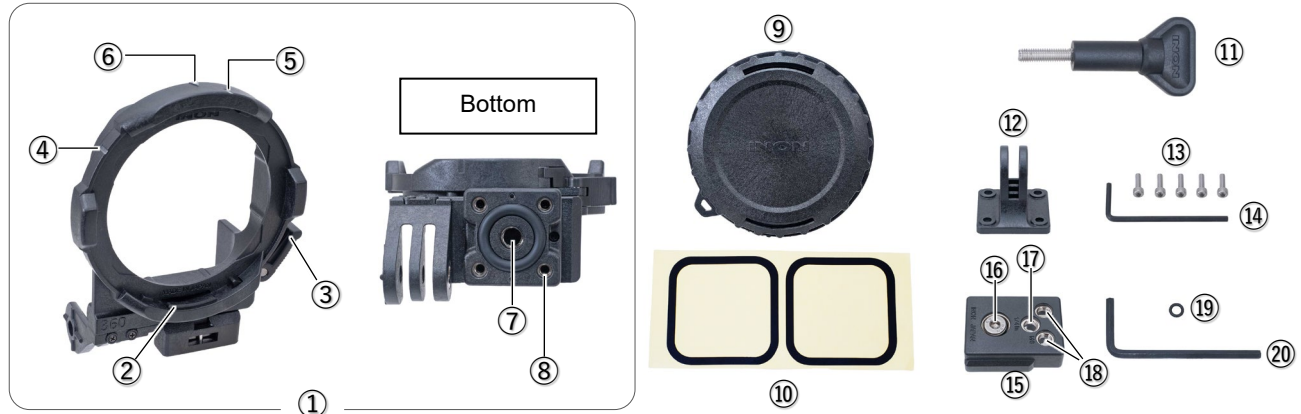

- ① ZD Front Mask for Ace Pro
- ② Lens Mount (ZD bayonet mount)
- ③ Lock Lever
- ④ Guide A (Lens)
- ⑤ Guide B (Lens)
- ⑥ Guide C (Hood)
- ⑦ Optional Accessory Fixing Hole (M6 screw hole)
- ⑧ Male Adapter Fixing Hole (M3 screw hole x4)
- ⑨ Front Cap
- ⑩ Anti-reflection Sticker (Ace Pro)

- ⑪ M5 Thumbscrew
- ⑫ Male Adapter
- ⑬ Male Adapter Fixing Screw ×5 including one spare.
- ⑭ Allen Wrench (WAF:2.5mm)
- ⑮ Mount Adapter
- ⑯ M6×12 Low Head Cap Screw\*  
\*pre-installed on the Mount Adapter
- ⑰ Tripod Screw Hole (1/4in. screw hole)
- ⑱ D5 Holder Fixing Hole (M6 screw hole ×2)
- ⑲ Spare O-ring (to hold M6x12 Low Head Cap Screw)
- ⑳ Allen Wrench (WAF:4mm)

### Compatible Product

#### Compatible camera/housing

- Insta360 Dive Case for Ace Pro (\*1)

#### Compatible ZD Mount Lens

- INON UFL-GR140 ZD Underwater Semi-fisheye Conversion Lens \*Supports all FOV
- INON UFL-G140 ZD Underwater Semi-fisheye Conversion Lens \*Supports up to “Dewarp”
- INON UCL-G165II ZD Underwater Wide Close-up Lens \*Supports excluding setting combinations of [UltraWide] + 4K/4:3, [ActionView] + 4K/16:9.

#### Compatible products attached on the [bottom] of this product

- INON Direct Base III, Z Joint, Z Adapter MV, Quick Holder Set S-Z, Shoe Base M6, Light Adapter for GoPro®

#### Compatible products attached on the [bottom] via packaged [Mount Adapter]

- INON D5 Holder, Shoe Base 1/4-20UNC, UW Tripod Hub, UW 3-Way Panhead
- Commercially available monopod, tripod

#### Compatible products attached on the [bottom] via packaged [Male Adapter]

- INON Ball Adapter for GoPro, Compact Grip Base for GoPro
- GoPro/Insta360 compatible mount

(\* 1) Insta360 Dive Case for Insta360 Ace Pro is the only compatible housing and any other housing is **not** usable with this product including Insta360 Dive Case for Insta360 Ace Pro 2.

## Front Cap

The product is shipped as shown in the image. Press the lock lever of the Front Mask to unlock then rotate the Front Cap counterclockwise to remove it.

You can attach the Front Cap, when the attachment lens is not in use, to protect the surface of the Dive Case.



## Anti-reflection Sticker

The red line around camera lens may appear as a reflection in the image, so please attach the supplied "Anti-reflection Sticker" to the camera.

- Peel off a bit of the sticker from the base and apply it to the lens frame, aligning it with the corner of the frame.
- Remove all remaining sticker from the base and stick it around the entire lens frame.



## Installation

- Set the camera in the Dive Case
- Set the **ZD Front Mask for Ace Pro** on the Dive Case with INON logo facing front. Make sure there is no gap between the lens frame of the housing and the opening edge of this product.
- Fasten this product and the Dive Case with the bundled M5 Thumbscrew.



## Lens Installation

- Match Guide A [Lens] with Guide A [Mask] as in below left image and put the male bayonet mount of the lens in the ZD bayonet mount of this product.
- Rotate the lens clockwise until Guide A [Lens] is coupled with Guide B [Mask] where you should feel and hear clicking
- When removing the lens, with pressing the **Lock Lever**, rotate the lens counterclockwise.

**! When unlocking, press the lock lever in firmly before turning the lens.** Otherwise, the lock will not be released. (If force is applied to the lens before pressing the lock lever, the lock will not be released.)



- Once submerged, remove the lens underwater and shake it well to drop trapped bubbles especially from the rear lens surface then install the lens on the ZD Front Mask again following same procedure.

## Male Adapter Installation

Place the adapter on the bottom of this product and fix with supplied 4 x Male Adapter Fixing Screws by using supplied Allen Wrench (WAF: 2.5mm). Using **Male Adapter** allows to attach optional accessories as per “selfie set” shown in the right.

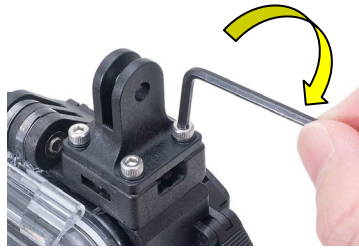
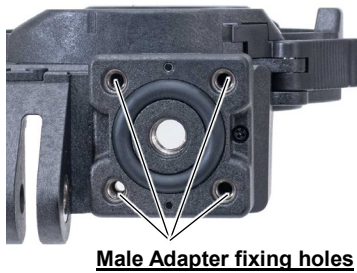

## Direct Base III, Quick Hoder Set S-Z, Z Adapter MV Installation

Directly attachable at “M6 Screw Hole” on the bottom of this product.



## Monopod, Tripod Installation via Packaged Mount Adapter

Attach the packaged **Mount Adapter** on the bottom of this product as in below images. Fasten it by pre-installed M6 Screw on the **Mount Adapter** firmly screwed into M6 Screw Hole by using supplied Allen Wrench (WAF: 4mm). A tripod etc. can be attached at Tripod Screw Hole (1/4in. screw hole) on the **Mount Adapter**.

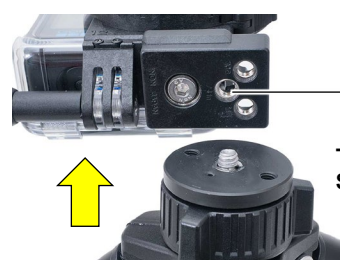
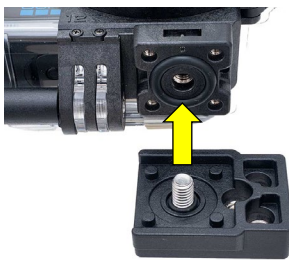

## D5 Holder via packaged Mount Adapter

Attach the packaged **Mount Adapter** on the bottom of this product as in below images. Fasten it by pre-installed M6 Screw on the **Mount Adapter** by firmly screwed it into M6 Screw Hole by using supplied Allen Wrench (WAF:4mm). Optional **D5 Holder** is attached on the left side of this product at “M6 screw holes” on the **Mount Adapter**.

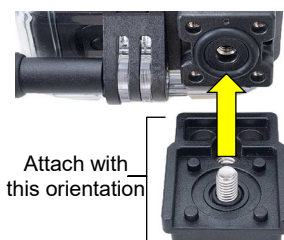

## Before Installation

- **DO NOT screw the “M5 Thumbscrew” to the Front Mask body strongly without the Dive Case to prevent accidental damage.**
- DO NOT inquire of Arashi Vision Inc./Insta360 installation of this product as it is not under the control of Arashi Vision Inc./Insta360. The user must take full responsibility for the installation/use of this product.
- INON Inc. shall not be liable for any failure of the housing, housing accessory or camera due to installation/use of this product.
- INON Inc. shall not be liable in any way for any incidental damages (such as expenses incurred in taking pictures/footages or loss of profit that should have been gained by the pictures/footages) that may result from flooding or other problems caused by the installation/use of this product
- **Installation and use of this product shall be deemed as full consent of the user to the above conditions.**

## Maintenance

- Apply thin film of grease to the top edge of screw shaft of adapters, base to prevent anchoring due to salt build-up.
- After use, rinse with fresh water to remove salt and other stains, and place in a well-ventilated area out of direct sunlight to dry thoroughly. DO NOT expose directly to fire or heat as this may cause deformation or damage.
- DO NOT use organic solvents such as alcohol, benzene, thinner, or oils/chemicals such as rust inhibitors, lubricants, glazing agents, or detergents (especially alkaline detergents) when cleaning the product. Some of the components of this product may change when exposed to the above substances, such as melting or becoming brittle.
- If the product is not used for more than a week, please remove and store it. Storing the product being attached on the combined product for extended period may cause deformation/damage due to continuous force applied to the combined product.

## Specifications

### INON ZD Front Mask for Ace Pro Specifications (\*1)

Model	ZD Front Mask for Ace Pro
Size (*excl. handle)	74.5mm/2.9in (W) × 95.4mm/3.8in (H)×41.2mm/1.6in (D)
Weight	Air: approx.60g/2.1oz, underwater approx. 25g/0.9oz
Material/surface finishing	PC, POM etc.

(\*1) Subject to change without prior notice

(\*2) “Insta360” is trademark or registered trademark of Arashi Vison Inc.

INON Inc.

2-18-9, Dai, Kamakura,  
Kanagawa 247-0061 JAPAN  
E-mail support@inon.co.jp  
Fax. +81(0)467-48-2178  
URL <http://www.inon.jp/>

February 2025