

# INON

## INON ZD Front Mask for HERO12

Thank you for purchasing INON product.

The INON “ZD Front Mask for HERO12” is a multi-purpose product to attach INON ZD Mount lens, arm etc. on GoPro genuine dive housing for HERO13/12/11/10/9 Black.

### Package, Name of Parts

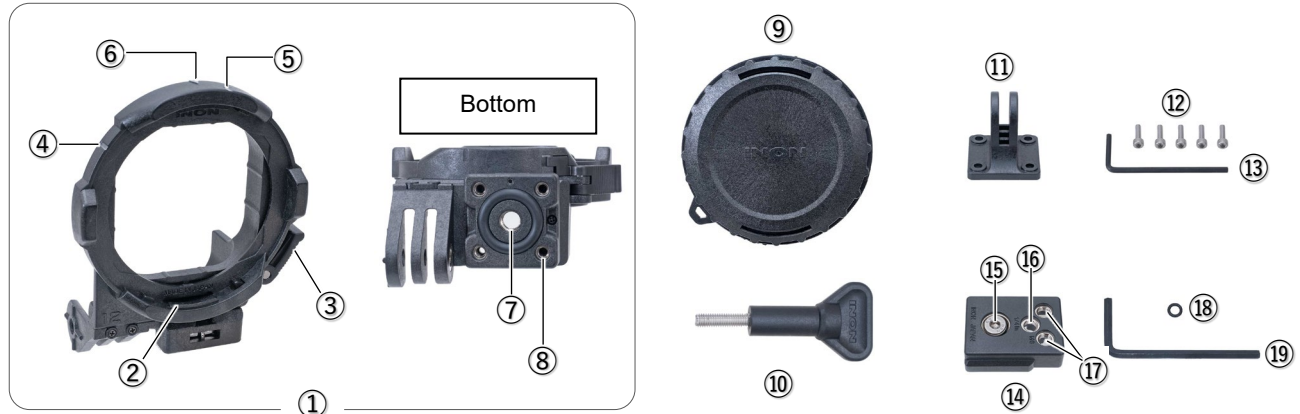

- ① ZD Front Mask for HERO12
- ② Lens Mount (ZD bayonet mount)
- ③ Lock Lever
- ④ Guide A (Lens)
- ⑤ Guide B (Lens)
- ⑥ Guide C (Hood)
- ⑦ Optional Accessory Fixing Hole (M6 screw hole)
- ⑧ Male Adapter Fixing Hole (M3 screw hole x4)
- ⑨ Front Cap
- ⑩ M5 Thumbscrew

- ⑪ Male Adapter
- ⑫ Male Adapter Fixing Screw ×5 including one spare.
- ⑬ Allen Wrench (WAF:2.5mm)
- ⑭ Mount Adapter
- ⑮ M6×12 Low Head Cap Screw\*  
\*pre-installed on the Mount Adapter
- ⑯ Tripod Screw Hole (1/4in. screw hole)
- ⑰ D5 Holder Fixing Hole (M6 screw hole ×2)
- ⑱ Spare O-ring (to hold M6x12 Low Head Cap Screw)
- ⑲ Allen Wrench (WAF:4mm)

### Compatible Product

#### Compatible camera/housing

- GoPro genuine dive housing for HERO13/12/11/10/9 Black (\*1)

#### Compatible ZD Mount Lens

- INON UFL-GR140 ZD Underwater Semi-fisheye Conversion Lens *\*Supports all FOV*
- INON UFL-G140 ZD Underwater Semi-fisheye Conversion Lens *\*Supports up to “4:3” frame/aspect ratio”*
- INON UCL-G165II ZD Underwater Wide Close-up Lens
- INON UCL-G100 ZD Underwater Close-up Lens
- INON UCL-G55 ZD Underwater Close-up Lens

#### Compatible products attached on the [bottom] of this product

- INON Direct Base III, Z Joint, Z Adapter MV, Quick Holder Set S-Z, Shoe Base M6, Light Adapter for GoPro®

#### Compatible products attached on the [bottom] via packaged [Mount Adapter]

- INON D5 Holder, Shoe Base 1/4-20UNC, UW Tripod Hub, UW 3-Way Panhead
- Commercially available monopod, tripod

#### Compatible products attached on the [bottom] via packaged [Male Adapter]

- INON Ball Adapter for GoPro, Compact Grip Base for GoPro
- GoPro/Insta360 compatible mount

(\* 1) GoPro genuine dive housing for HERO13/12/11/10/9 Black is the only compatible housing and any other housing is not usable with this product.

## Front Cap

The product is shipped as shown in the image. Press the lock lever of the Front Mask to unlock then rotate the Front Cap counterclockwise to remove it.

You can attach the Front Cap, when the attachment lens is not in use, to protect the surface of the housing.



## Installation

- Set the camera in the Dive Housing.
- Set the **ZD Front Mask for HERO12** on the Dive Housing with INON logo facing front. Make sure there is no gap between the lens frame of the housing and the opening edge of this product.
- Fasten this product and the Dive Housing with the bundled M5 Thumbscrew.



## Lens Installation

- Match Guide A [Lens] with Guide A [Mask] as in below left image and put the male bayonet mount of the lens in the ZD bayonet mount of this product.
- Rotate the lens clockwise until Guide A [Lens] is coupled with Guide B [Mask] where you should feel and hear clicking
- When removing the lens, with pressing the Lock Lever, rotate the lens counterclockwise.

**⚠ When unlocking, press the lock lever in firmly before turning the lens.** Otherwise, the lock will not be released. (If force is applied to the lens before pressing the lock lever, the lock will not be released.)



- Once submerged, remove the lens underwater and shake it well to drop trapped bubbles especially from the rear lens surface then install the lens on the ZD Front Mask again following same procedure.

## Male Adapter Installation

Place the adapter on the bottom of this product and fix with supplied 4 x Male Adapter Fixing Screws by using supplied Allen Wrench (WAF: 2.5mm). Using **Male Adapter** allows to attach optional accessories as per “selfie set” shown in the right.

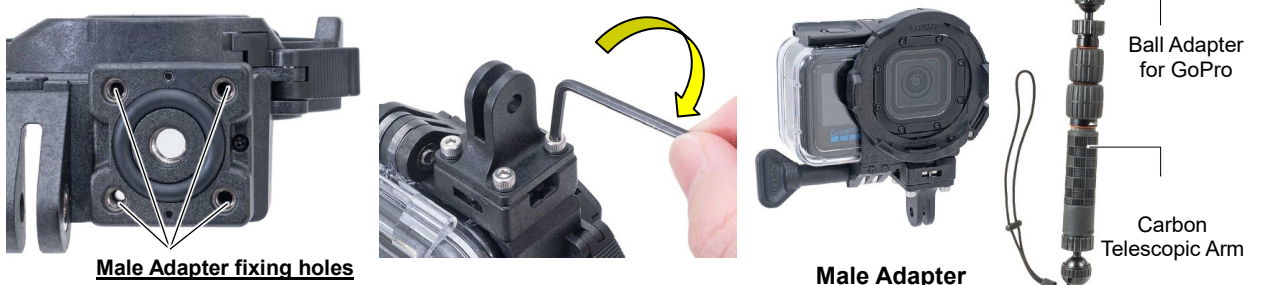

## Direct Base III, Quick Hoder Set S-Z, Z Adapter MV Installation

Directly attachable at “M6 Screw Hole” on the bottom of this product.



**M6 Screw Hole**



**Direct Base III**



**Quick Holder Set- S-Z**



**Z Adapter MV**

## Monopod, Tripod Installation via Packaged Mount Adapter

Attach the packaged **Mount Adapter** on the bottom of this product as in below images. Fasten it by pre-installed M6 Screw on the **Mount Adapter** firmly screwed into M6 Screw Hole by using supplied Allen Wrench (WAF: 4mm). A tripod etc. can be attached at Tripod Screw Hole (1/4in. screw hole) on the **Mount Adapter**.

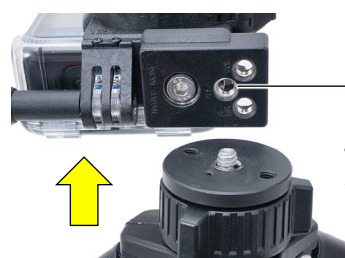
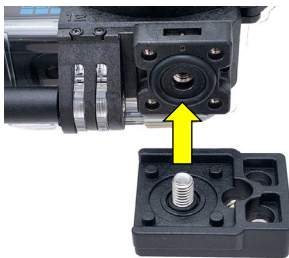

**Tripod Screw Hole**



## D5 Holder via packaged Mount Adapter

Attach the packaged **Mount Adapter** on the bottom of this product as in below images. Fasten it by pre-installed M6 Screw on the **Mount Adapter** by firmly screwed it into M6 Screw Hole by using supplied Allen Wrench (WAF:4mm). Optional **D5 Holder** is attached on the left side of this product at “M6 screw holes” on the **Mount Adapter**.

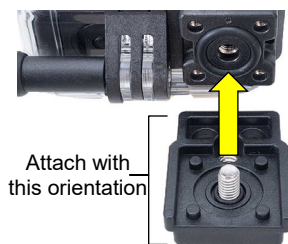

Attach with this orientation



**M6 screw holes**



**D5 Holder**

## Before Installation

- **DO NOT screw the “M5 Thumbscrew” to the Front Mask body strongly without the Dive Housing to prevent accidental damage.**
- **DO NOT** inquire of GoPro Inc. installation of this product as it is not under the control of GoPro Inc. The user must take full responsibility for the installation/use of this product.
- INON Inc. shall not be liable for any failure of the housing, housing accessory or camera due to installation/use of this product.
- INON Inc. shall not be liable in any way for any incidental damages (such as expenses incurred in taking pictures/footages or loss of profit that should have been gained by the pictures/footages) that may result from flooding or other problems caused by the installation/use of this product
- **Installation and use of this product shall be deemed as full consent of the user to the above conditions.**

## Maintenance

- Apply thin film of grease to the top edge of screw shaft of adapters, base to prevent anchoring due to salt build-up.
- After use, rinse with fresh water to remove salt and other stains, and place in a well-ventilated area out of direct sunlight to dry thoroughly. **DO NOT** expose directly to fire or heat as this may cause deformation or damage.
- **DO NOT** use organic solvents such as alcohol, benzene, thinner, or oils/chemicals such as rust inhibitors, lubricants, glazing agents, or detergents (especially alkaline detergents) when cleaning the product. Some of the components of this product may change when exposed to the above substances, such as melting or becoming brittle.
- If the product is not used for more than a week, please remove and store it. Storing the product being attached on the combined product for extended period may cause deformation/damage due to continuous force applied to the combined product.

## Specifications

### INON ZD Front Mask for HERO12 Specifications (\*1)

Model	ZD Front Mask for HERO12
Size (*excl. handle)	74.5mm/2.9in (W) × 92.3mm/3.6in (H)×40.1mm/1.6in (D)
Weight	Air: approx.60g/2.1oz, underwater approx. 25g/0.9oz
Material/surface finishing	PC, POM etc.

(\*1) Subject to change without prior notice

(\*2) “GoPro”, “HERO” is trademark or registered trademark of GoPro Inc.

INON Inc.

2-18-9, Dai, Kamakura,  
Kanagawa 247-0061 JAPAN  
E-mail support@inon.co.jp  
Fax. +81(0)467-48-2178  
URL <http://www.inon.jp/>

November 2024