

INON

INON Monitor Housing for LVR3

Thank you for purchasing INON product.

INON Monitor Housing for LVR3 is a dedicated underwater housing(*3) for Sony Live-View Remote 『RM-LVR3』 (*1) which is bundled with Sony Action Cam 『FDR-X3000R』 (*1)/ 『HDR-AS300R』 (*1). The Monitor Housing for LVR3 is attached on INON 『SD Mount Base UWH1』 (*2) to use Sony Live-View Remote 『RM-LVR3』 underwater.

Features

- Simply yet rigid cylinder shape underwater housing with 60m (197ft) depth rating supporting power switch operation.
- This product is attached on the SD Mount Base UWH1 to use the live-view monitor underwater.
- Packaged Shade Hood suppresses reflection of the monitor supporting comfortable visual contact even in bright conditions. The Shade Hood is removable as necessary.
- The Shade Hood is equipped with 360 degree rotatable flange to cut unnecessary ambient light from any direction.
- The lid has conventional M52 screw mount enabling to attach INON 「UCL-165M67」/「UCL-330」 close-up lens via optional 「Step-up Ring 52-67」 to magnify the monitor image. (*4)

*1: Contact Sony Marketing Inc. for detail of camera / Live-View Remote. INON Inc. confirms product compatibility based on a camera available in Japan.

*2: The Live-View Remote is only useable when the Monitor Housing is appropriately attached on the 『SD Mount Base UWH1』 as per this instruction. Otherwise the Live-View Remote cannot establish connection with the camera.

*3: The Monitor Housing allows to control On/Standby button only, go to camera controls for all other controls/settings.

*4: Attaching 「UCL-165M67」 magnifies monitor image by approx.15% and 「UCL-330」 magnifies by approx. 8%.

Using more powerful lens than the 「UCL-165M67」 will have vignetting on image corners.

Name of parts / Packaged accessories

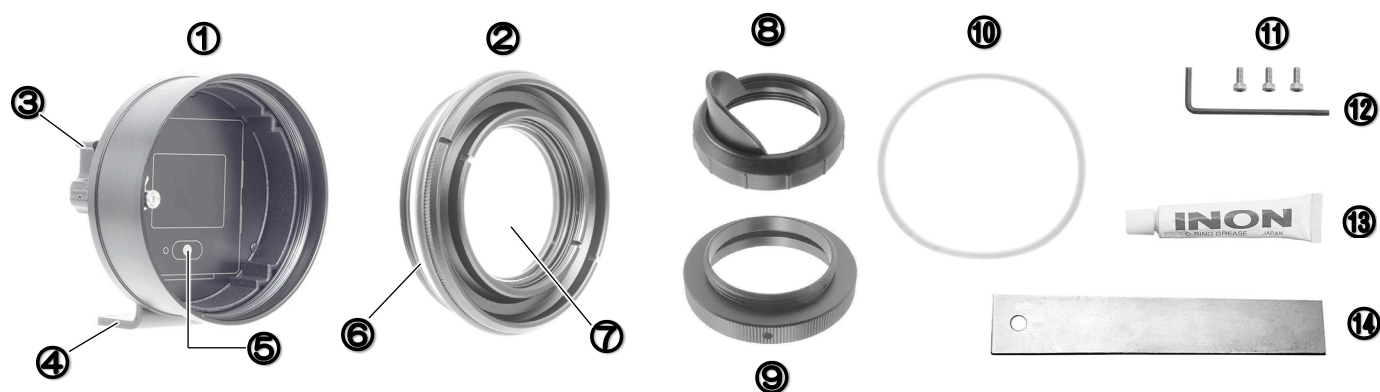

1. Monitor Housing
2. Monitor Housing Lid
3. Power Switch Lever
4. Fixing Plate
5. Positioning illustration

6. Yellow O-ring
7. Monitor Glass
8. Shade Hood
9. Shade Hood Adapter
10. Spare O-Ring

11. M3x8 Cap Screw x 3 (incl. one spare)
12. Allen Wrench (WAF:2.5mm)
13. INON Grease
14. Lid Opener
15. This user manual

Compatible Products : ·Sony 『FDR-X3000R』 / 『MPK-UWH1』 + INON 「SD Mount Base UWH1」
(as of March 2017) ·Sony 『HDR-AS300R』 / 『MPK-UWH1』 + INON 「SD Mount Base UWH1」

(*This product only supports Live-View Remote kit)

Camera/Live-View Remote Setting :

- Make necessary settings on the Live-View Remote before put it in the Monitor Housing as the housing allows to control ON/Standby button only.
- Always set 「Auto monitor off while shooting (AUTO DISP OFF)」 to 【OFF】 or the monitor is automatically turned off after certain period.
- INON Inc. confirms its usability under various water temperatures, salinity, battery level. Should connection between camera and Live-View Remote fail, try to turn on 「Wi-Fi Hi power setting」 on camera side. (though battery is running out faster)
- It is recommended to turn off Wi-Fi when the Live-View Remote is not in use to extend battery usage.

Usage:

Installation

- Place the Live-View Remote in the Monitor Housing to match with the positioning illustration. Improper installation of the Live-View Remote will obstruct ON/Standby button operation.
- Check the O-ring on the Monitor Housing Lid and O-Ring contact surface of the Monitor Housing to make sure they do not have any damage or foreign particles then uniformly apply thin film of supplied INON Grease on the O-ring contact surface.
- Slowly and lightly tighten the lid clockwise by hand until it stops.
- Attach the Fixing Plate on SD Mount Base UWH1 at 2 x M3 Screw Holes on its back with supplied 2 x M3x8 Cap Screws by using supplied Allen Wrench (WAF:2.5mm).



「Shade Hood」 Installation

Attach「Shade Hood」 via packaged 「Shade Hood Adapter」. Rotate the flange to adjust its position.

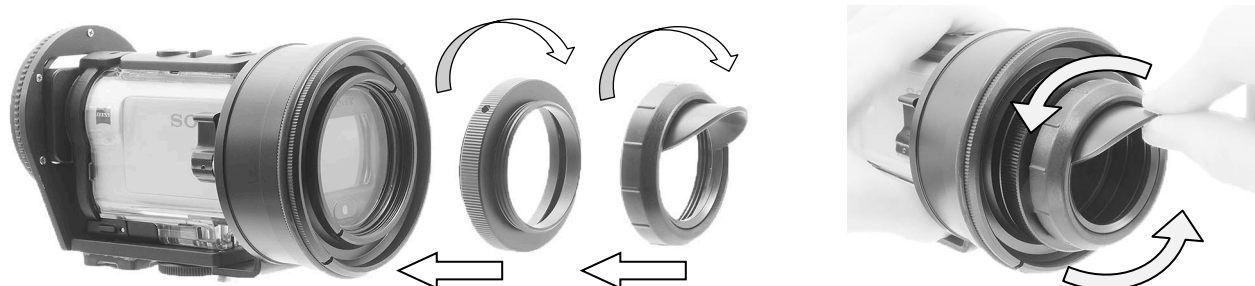

How to power ON/Standby

Push Power Switch Lever turns on/off the Live-View Remote.



Open the Monitor Housing Lid with the Lid Opener

Should you find difficulty to open the lid by hand, use supplied 「Opening Tool」 as shown in image and turn the lid counter-clockwise to open.

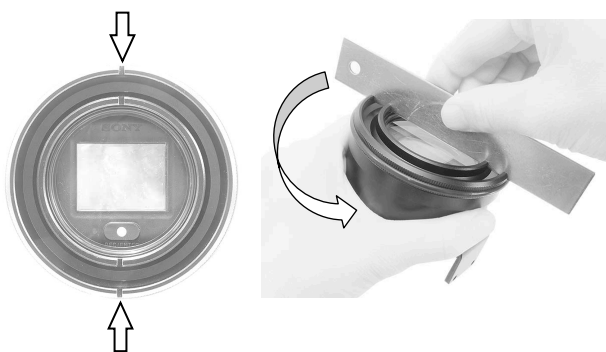

- Maintenance** :
- After using, soak in fresh water to dissolve remaining salt or remove dirt and dry it in shaded and well-ventilated area with no water drops on the lens surface. Remaining water on the lens surface may cause burn/spot. Never apply flame or direct heat to this product or damage may result.
 - Apply a little amount of grease on the O-ring and O-ring contact surface to prevent anchoring between this product and the lid. Always use INON grease and do not apply other grease, which may cause the O-ring to swell or deform, causing poor seal and water leakage.
 - DO NOT clean with organic solvent like alcohol, benzene or thinner and oil and fat containing/chemical material like rust inhibitor, lubricant, polish, detergent(especially alkaline detergent) to avoid damage/deformation/degradation of this product.

- Handling precautions** :
- Protect from impact shock and vibration, such as vibrating boat deck to prevent malfunction or flooding of the product.
 - Do not expose to extra heat, such as inside of a sun-heated car, or in hot direct sunlight, such as a beach or boat deck. Doing so may cause damage and subsequent flooding.
 - This product is designed to withstand external pressure (water pressure), but not internal pressure (when ambient air pressure decreases). When traveling to or from high altitudes, including travel on an aircraft, always remove or loosen the “Monitor Housing Lid”.
 - Please note that camera/Live-View Remote manufacture has no concern with installation of this product on them. **DO NOT** inquire the manufacture about the installation. Also please note that you have to take full responsibility for the installation.
 - INON Inc. cannot take any responsibility for any trouble/damage (damage to camera/Live-View Remote and accessories of camera/Live-View Remote) resulting from the installation.
 - Should you have trouble like flooding caused by the installation, INON Inc. cannot take any responsibility for incidental damage (relevant expense to take a shot etc.).
 - **Please perform the installation only if you can accept above conditions.**

- Options** :
- Spare O-Ring (Monitor Housing for LVR3)
⑩ in the packaged accessory shown on the first page of this manual

- SD Mount Base UWH1
A multi-purpose base equipped with “SD mount” bayonet system to attach compatible INON SD Mount lenses and adapters on compatible action camera and its housing. As for February 2017, supported model is Sony 「MPK-UWH1」(genuine housing for「FDR-X3000」「HDR-AS300」).

- UFL-G140 SD Underwater Semi-fisheye Conversion Lens

An underwater semi-fisheye conversion lens to use with above SD Mount Base UWH1 to increase native coverage of the action camera underwater to 『approx. 140 degrees』. The lens also shorten minimum focusing distance to capture a subject from only a few centimeters away from a subject to produce dynamic effect.

- UCL-G165 SD Underwater Wide Close-up Lens
An underwater wide close-up lens to use with above SD Mount Base UWH1 to drastically shorten minimum focusing distance to deliver close-up/high magnification imaging. This lens is designed to widen native underwater coverage of action camera to approx. 『110 degrees』 to have more depth of field not as like a standard close-up lens.



- Step-up Ring 52-67

This Adapter allows attaching the UCL-165M67/UCL-330 on the Monitor Housing Lid to magnify monitor view.



- UCL-165 M67 Close-up Lens

- UCL-330 Close-up Lens

Usable close-up lens on this product via 「Step-up Ring 52-67」.

The 「UCL-165M67」magnifies monitor image by approx. 15% and the 「UCL-330」 magnifies by approx. 8%.

(Using more powerful lens than 「UCL-165M67」 will have vignetting on image corners)



INON Monitor Housing Specifications [*1]	
Model	Monitor Housing for LVR3
Size(*excluding protruded parts)	φ80.2mm/3.16in x 36.1mm/1.42in [φ80.2mm/3.16in x 71.8mm/2.83in with packaged Shade Hood being installed]
Weight	207g/7.3oz (air) / approx.65g/2.3oz (underwater) [237g/8.4oz (air) / approx.80g/2.8oz (underwater) with packaged shade hood]
Material / finishing	Corrosion resistant aluminium alloy / rigid black alumite / PC, etc.

*1 Subject to change without prior notice

*2 All brand name, product name and function name in this manual are trademarks or registered trademarks of respective manufactures

INON Inc.
2-18-9, Dai, Kamakura,
Kanagawa 247-0061 JAPAN
E-mail support@inon.co.jp
Fax. +81(0)467-48-2178
URL http://www.inon.jp/

March 2017