

INON

INON SD Front Mask STD

Thank you for purchasing INON product.

INON SD Front Mask STD is a multi-purpose product to attach INON SD Mount series attachment lens, arm etc. on a genuine standard housing (depth rating: 40m/131 ft. *Option for GoPro® HERO3) for GoPro® 「HERO4」/「HERO3+」/「HERO3」and GoPro® 「HERO」/「HERO+」/「HERO+LCD」.

Features

- INON “**SD Mount**” bayonet system with locking system. With 「SD Mount」, INON 「UFL-G140 SD」underwater semi-fisheye conversion lens (*2) or 「UCL-G165 SD」 underwater wide close-up lens (*2) exclusively designed for an action camera like GoPro® camera, can be easily, quickly and reliably mounted/detached underwater. Of course the SD Front Mask STD is usable without any attachment lens (*1)
- INON 「Direct Base III」, 「Z Joint」 or 「Z Adapter MV」 can be attached on the bottom of the SD Front Mask STD.
- Installing packaged Male Adapter (GoPro®) on the bottom of this product utilizes your GoPro® compatible accessories.
- Packaged Mount Adapter enables to add the optional D Holder* as well as monopod or tripod on the bottom of this product. (*left side only)
- Compatible with LCD BackPac™, Battery BackPac™ .

Name of parts/ Packaged accessory

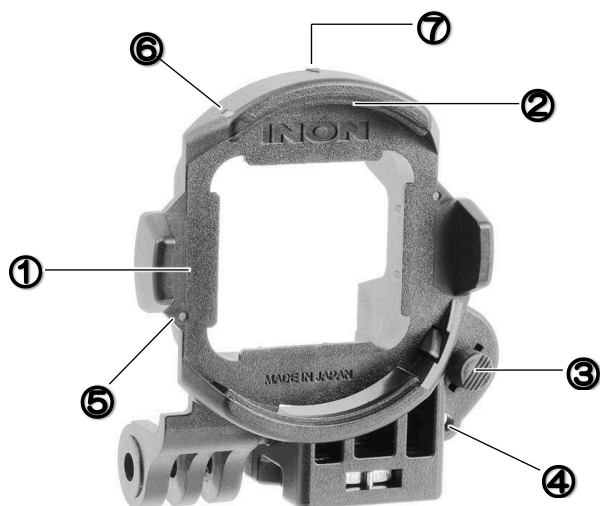

1. SD Front Mask STD body
2. Lens Mount (SD bayonet mount)
3. Lock Button
4. Strap Hole (Diameter: ϕ 3.2mm)

Body 【bottom】

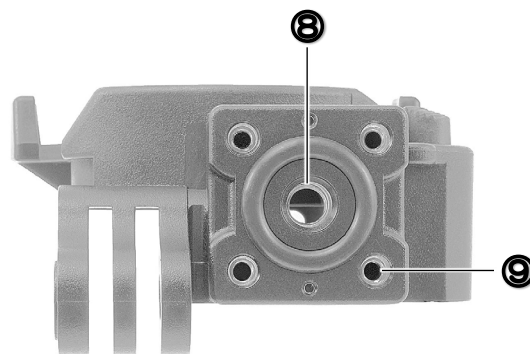

5. Guide A (Lens) x2
6. Guide B (Lens) x2
7. Guide C (Lens Hood)
8. Optional Accessory Fixing Hole (M6)
9. Male Adapter Fixing Hole (M3 screw x4)

Packaged accessory

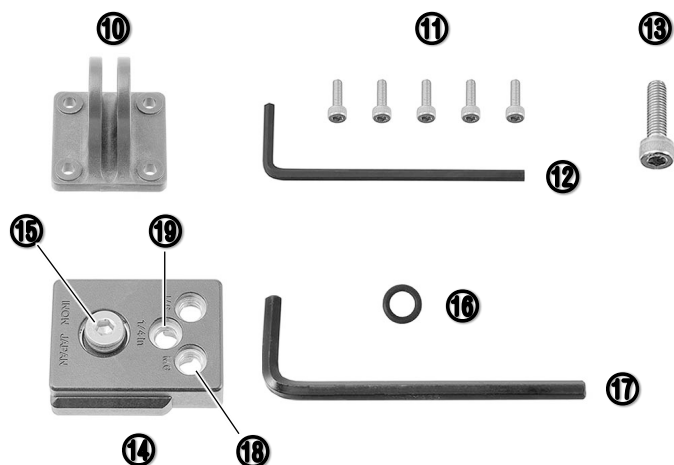

10. Male Adapter (GoPro®)
11. Male Adapter Fixing Screw x5*
*including one spare.
12. Allen Wrench 2.5mm
13. M5×18 Cap Screw
14. Mount Adapter for SD Front Mask STD
15. M6×12 Low Head Cap Screw*
*pre-installed on Mount Adapter
16. Spare O-ring (hold M6x12 Low Head Cap Screw)
17. Allen Wrench 4mm
18. D Holder Fixing Hole (M6 screw hole x2)
19. Tripod Screw Hole (1/4in. screw hole)
20. This user manual

Compatible housing/camera
(as of February 2016)

- ・ Genuine standard housing (depth rating: 40m/131 ft.) for GoPro®「HERO4」 「HERO3+」 「HERO3」(*3)
- ・ GoPro®「HERO」 「HERO+」 「HERO+LCD」

Compatible lens and Optional Parts

(as of February 2016)

- ・ SD Mount Lens
 - INON「UFL-G140 SD」underwater semi fisheye lens (*2)
 - INON「UCL-G165 SD」underwater wide close-up lens (*2)
- ・ Compatible products attached on the [bottom] of this product
 - INON「Direct Base III」 「Z Joint」 「Z Adapter MV」
- ・ Compatible product attached on the [bottom] via packaged [Mount Adapter]
 - INON「D Holder」

- *1: When using on land, set FOV mode other than 「Wide」 or use without this product to prevent vignetting observed mainly in ultra wide mode even without an attachment lens. (No vignetting underwater)
- *2: Both 「UFL-G140 SD」 and 「UCL-G165 SD」 are designed for underwater use only and not usable on land.
- *3: Compatible housing is “Standard Housing (40m/131ft)”. The “Dive Housing (60m/197ft)” packaged with “GoPro® HERO3” is not compatible.

Installation method:

- (a) Set your 「HERO4」, 「HERO3+」 or 「HERO3」 in genuine Standard Housing.
Optional 「LCD BacPac™」 or 「Battery BacPac™」 is usable with this product.
- (b) Set SD Front Mask STD on the housing with INON logo facing front. Make sure there is no gap between the lens frame of the housing and the opening of this product.
- (c) Fasten this product and the housing with the thumb screw which comes with the housing.
- (d) Using the Male Adapter may require to use the thumb screw. You can still substitute supplied 「M5x18 Cap Screw」 for the thumb screw. Tighten 「M5x18 Cap Screw」 firmly by using supplied Allen Wrench(4mm). DO NOT tighten too much to avoid an accidental damage.



Installing accessory :

“Male Adapter (GoPro®)”

Place the adapter on the bottom of this product and fix with supplied 4 x Male Adapter Fixing Screws by using supplied Allen Wrench (2.5mm).

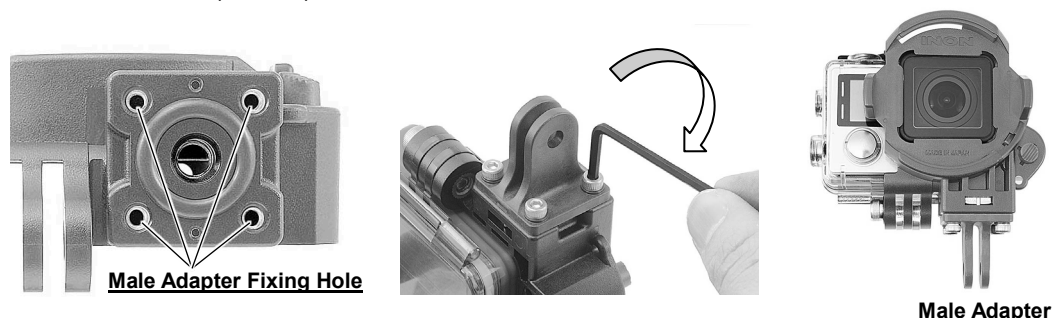

「Direct Base III」 「Z Joint」 「Z Adapter MV」

Directly attachable at “M6 Screw Hole” on the bottom of this product.



「D Holder」 via 「Mount Adapter for SD Front Mask STD」

Attach the Mount Adapter for SD Front Mask STD on the bottom of this product. Fasten it by pre-installed M6 Screw on the Mount Adapter screwed into M6 Screw Hole. Fix firmly by using supplied Allen Wrench (4mm).

Optional D Holder is attached at 2 x D Holder Fixing Hole on the Mount Adapter. (Left side only)

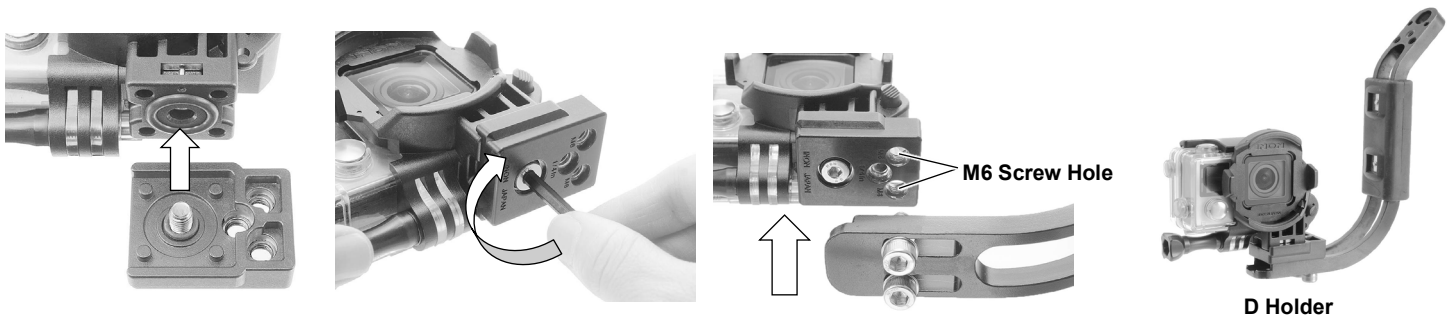

「Monopod」 「Tripod」 via 「Mount Adapter for SD Front Mask STD」

Insert the pre-installed M6 Screw of the supplied Mount Adapter into M6 Screw Hole and fix firmly by using supplied Allen Wrench (4mm).

A tripod can be attached at Tripod Screw Hole (1/4in. screw hole) on the Mount Adapter.

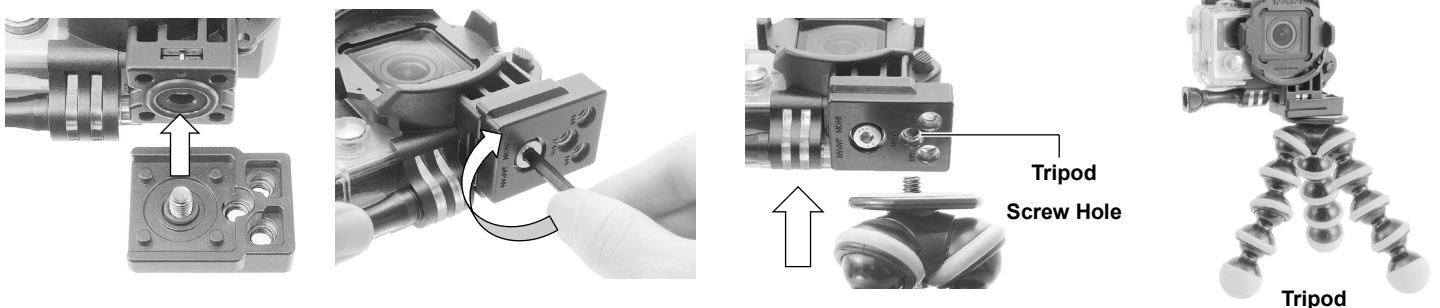

INON attachment lens, 「UFL-G140SD」/「UCL-G165 SD」

- Match **「Guide A」** of this lens with **「Guide A」** of the SD Front Mask and put the bayonet mount of the lens in the SD Mount.
- Rotate the lens clockwise until **「Guide A」** of this lens is coupled with **「Guide B」** of the SD Front Mask where you should feel and hear clicking.
- When remove the lens from the SD Front Mask, push the **「Lock Button」** to release the lock then rotate the lens counterclockwise.



- Remove the lens underwater and shake it well to drop trapped bubbles from the rear lens surface then install the lens on the SD Front Mask STD.

Lens Hood 【UFL-G140SD only】

- Attach the lens on **SD Front Mask before the installation.**
- As shown in the below image, put the lens hood on the lens all the way until the screw hole under “INON logo” aligns with the 『Guide C』 on the SD Front Mask. Make sure to put the lens hood all the way down to the end. Misalignment or incomplete installation will cause vignetting.
- Lightly and evenly tighten hollow screws diagonally without the changing the lens hood position by supplied Allen Wrench. Too much or uneven tightening will damage the lens hood.

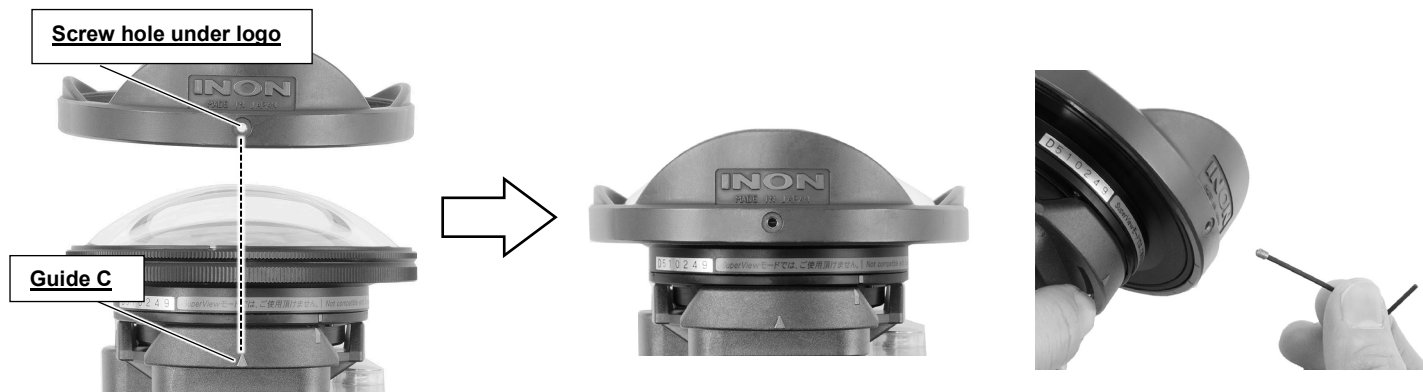

Maintenance

- **Whenever installing a cap screw, make sure to apply a thin film of grease on the edge of the threaded screw shaft to prevent anchoring due to salt build-up.**
- After using, soak in fresh water to dissolve remaining salt or remove dirt and dry it in shaded and well-ventilated area. Never apply flame or direct heat to this product or damage may result..
- **DO NOT** clean with organic solvent like alcohol, benzene or thinner and oil and fat containing/chemical material like rust inhibitor, lubricant, polish, detergent(especially alkaline detergent) to avoid damage/deformation/degradation of this product.
- Remove the SD Front Mask from the housing when not using more than one week to avoid damage/deformation of compatible product resulting from continuous pressure.



Handling precautions

- It is necessary to remove this product from the housing to take out the camera or replace the backdoor. Remove this product when you need to change camera battery, remove storage card or replace the backdoor.
- Please note that camera/housing manufacture has no concern with installation of this product on housing. **DO NOT** inquire camera/housing manufacture about the installation. Also please note that you have to take full responsibility for the installation.
- The installation of this product may void camera/housing warranty even warranty period has not yet expired. Please check hosing user manual/warranty certificate for detail of warranty condition of your housing.
- INON Inc. cannot take any responsibility for any trouble/damage (damage to housing/housing accessories /camera) resulting from the installation.
- **Please perform the installation only if you can accept above conditions.**

Options

- **UFL-G140 SD Underwater Semi-fisheye Conversion Lens**
An underwater semi-fisheye conversion lens to use with the 「SD Mount Cage」 or 「SD Front Mask」 to increase native coverage of GoPro® camera underwater 94 degrees to ultra wide 『140 degrees』. The lens also shorten minimum focusing distance to capture a subject from only a few centimeters away from a subject.
- **UCL-G165 SD Underwater Wide Close-up Lens**
An underwater wide close-up lens to use with the 「SD Mount Cage」 or 「SD Front Mask」 to drastically shorten minimum focusing distance to enable close-up/high magnification imaging by GoPro® camera. This lens is designed to widen native underwater coverage of GoPro® camera from 「94 degrees」 to 『110 degrees』 to have more depth of field not as like a standard close-up lens.



- Direct Base III

A ball-joint adapter to hold arm product with optional clamp on bottom of this product



- Z Adapter MV

A ball-joint adapter attachable on the bottom of this product. Since the ball-joint is protruded at an angle against its base, the ball-joint can be installed at different angles by rotating the adapter.



- Z Joint

An adapter attachable on the bottom of this product to attach on the “「YS Adapter」 compatible arm” products such as 「Shoe Base」, 「D Holder」 or 「YS Adapter MV」etc.



- D Holder

Optional grip holder to add INON arm system on the left side to hold a LED flash light etc. It also supports you to hold and carry the whole system by single hand comfortably.



- SD Mount Cage for HERO3/3+/4

A key component for the combination of GoPro® HERO3/HERO3+/4 with optional genuine dive housing (depth rating: 60m/197ft) to add INON SD Mount lenses and adapters to extend arm products. (*genuine standard housing (depth rating: 40m/131 ft.) is not compatible. This cage carries versatile usability to hold adapters on the both top/bottom surface. Optional 「D holders」 are attachable on both sides.



- Mount Adapter for SD Front Mask STD

A set of ⑭⑮⑯⑰ in the packaged accessory shown on the first page of this manual.

- Male Adapter (GoPro®)

A set of ⑩⑪⑫ in the packaged accessory shown on the first page of this manual.

INON SD Front Mask STD Specifications [*1]	
Model	SD Front Mask STD
Size (※excluding protruded parts)	67.9mm/2.7in.(W)×79.3mm/3.1in.(H)×37.8mm/1.5in.(D)
Weight	42g/1.5oz (air) / approx.13g/0.5oz (underwater)
Material/finishing	PC, POM etc.

*1 Subject to change without prior notice

*2 GOPRO, HERO, BacPac, are trademarks or registered trademarks of GoPro, Inc.

INON Inc.

2-18-9, Dai, Kamakura,
Kanagawa 247-0061 JAPAN

E-mail support@inon.co.jp

Fax. +81(0)467-48-2178

URL http://www.inon.jp/ February 2016