

# INON

## INON 28AD Port·PT-027/020

Thank you for purchasing INON product.

INON 28AD Port·PT-027/020 is to be replaced with 「PPO-01」 which is Olympus genuine port for Olympus 「PT-027」/「PT-020」 (genuine water-proof protector for 『C-7070WZ』 / 『C-5060WZ』 ), to have INON 28AD Mount series attachment lens and/or to have INON Arm system to attach INON Strobe.

INON 28AD Port is exclusively for Olympus 「PT-027」/「PT-020」.

### Features

- INON 28AD Mount (bayonet) compatible.  
INON 「UWL-100 28AD」 (exclusively designed for wide angle master lens of 28mm at wide end (equivalent to 35mm film size) can be attached/detached on the compatible protector through this 28AD Port. The 28AD Port can be used without attachment lens.
- Optional「AD Mount Converter for UCL-165AD」 enables to have INON「UCL-165AD Close-up Lens」 on the 28AD Port.
- INON 「Grip Base D4」 can be directly mounted on the 28AD Port to attach digital camera compatible INON S-TTL Auto strobe 「D-2000」 etc. The 28AD Port gives you simple and secure solution to have an external strobe.
- The port body employs machined aluminum alloy for high durability and inner AR coated optical glass for high image quality. A metal Base Plate supports the port body to prevent accidental dropping off or twisting and enables to have optional accessories without excessive load on the housing.

### Package contains:

- 28AD Port Unit ①
- Base Plate ②
- 1/4 Tripod Screw ③  
(Metal or black plastic screw depending on manufacturing lot)
- Cap Screw ④
- Allen Wrench ⑤
- This user manual

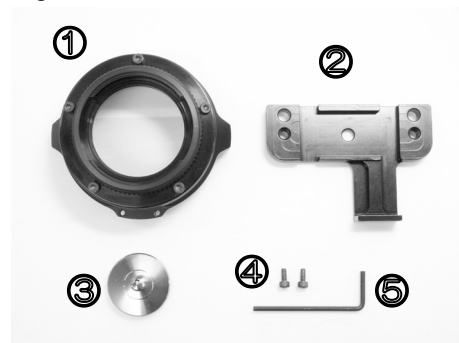

**Compatible housing:** • Olympus PT-027, PT-020  
(as of May 2009)

### Compatible lens and optional parts (as of May 2009)

- 28AD Mount Series
  - INON「UWL-100 28AD」Wide Conversion Lens (★)  
★: Negligible vignetting on image corners when using 「UWL-100 28AD (designed for master lens of 28mm focal length)」 with PT-027/020 (camera's master lens is 27mm at wide end).  
Take a shoot at wide end and crop the image.
- AD Mount Series
  - INON 「UCL-165AD」 Close-up Lens  
+ INON 「AD Mount Converter for UCL-165AD」 (★★)  
★★: Zoom forward until no vignetting is observed.
- Strobe accessories(★★★)
  - INON 「Grip Base D4」 [Strobe arm/Grip]

**Preparation** : It is necessary to detach Olympus genuine port 「PPO-01」 from the housing and attach the 28AD Port PT-027/020 with Olympus O-ring

Before executing any preparation, please carefully read through 「Handling precautions」 section of this manual and user manual/warranty policy of your housing to understand / confirm warranty policy of INON Inc. / housing manufacturer.

- Remove 「Black」O-ring from 28AD Port Unit as shown in image right.
- Detach 「PPO-01」 from 「PT-027」/「PT-020」 and remove pre-installed 「Red」 O-ring as shown in image right. Please see user manual of housing for detailed information how to detach 「PPO-01」and remove its O-ring.



## (Preparation)

- Check O-ring groove of the 28AD Port Unit and O-ring contact surface of the housing, and clean up any hair / lint / debris with cotton swab if necessary. Also check the O-ring groove and O-ring contact surface to make sure there is no crack/damage. Check 『Red』O-ring removed from 『PPO-01』 for presence of hair / lint / debris and wipe them off if necessary, and confirm there is no scratch/crack. Apply Olympus genuine grease on the 『Red』O-ring. Please refer to user manual of the housing.
- Install Olympus 『Red』 O-ring after maintenance. **DO Not install 『Black』 O-ring** which originally comes with the 28AD Port.

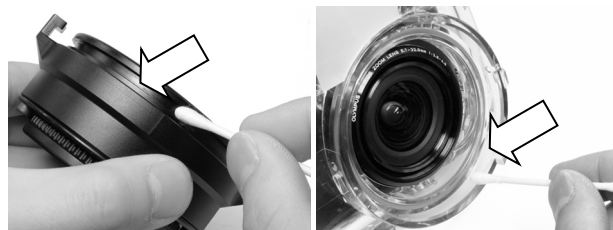

Attach 『Red』 O-ring of 『PPO-01』



The “Black” O-ring originally attached on the 28AD Port Unit is not for water-proof purpose but to protect 「O-ring groove」 of the 28AD Port Unit.

**Make sure to use 『Grease for Silicon O-ring(white cap) supplied with PT-027/020 for 『Preparation』 or maintenance of PT-027/020.**

Using other grease (including INON grease) will damage PT-027/PT-020/PPO-01 itself and the “Red” O-ring and lead to flooding.

## How to attach

### Attach 28AD Port Unit

Place 「PT-027」/「PT-020」 (without 「PPO-01」) with lens port side up and put the 「28AD Port Unit」 on it so that 『Guide A』 of the 「PT-027」 / 「PT-020」 and right edge of 『Guide B』 on the 「28AD Port」 is aligned.

「PT-027」/「PT-020」  
『Guide A』

「28AD Port Unit」  
『Guide B』

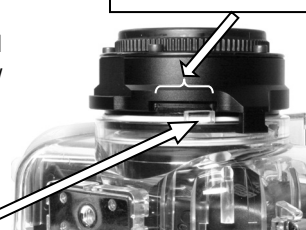

Slowly and straightly push the 「28AD Port Unit」 downwards in the direction of an arrow shown in right image so that the 『Guide A』 of the 「PT-027」 / 「PT-020」 fits into far right of the 『Guide B』 on the 「28AD Port Unit」 as shown in circle in image right. Make sure there is no gap at contact area between 28AD Port unit and the 「PT-027」/「PT-020」.

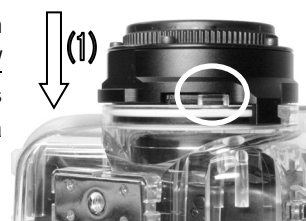

Gently rotate the 「28AD Port Unit」 counterclockwise until the 『Guide A』 of 「PT-027」/「PT-020」 touches to far left side of the 『Guide B』 of the 「28AD Port Unit」 with keeping the contact area stick together.

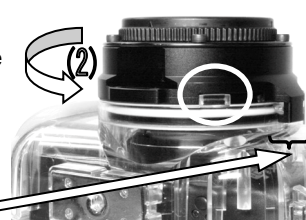

Two 『Pawls』 of 「28AD Port Unit」 grasp 『Boss』 of 「PT-027」/「PT-020」 (The image only shows one side)

Check to make sure following points

- 「28AD Port Unit」 and 「PT-027」/「PT-020」 coheres together without no gap all circumference around their contact area.
- Two 『Pawls』 of the 「28AD Port Unit」 grasp the 『Boss』 of 「PT-027」/「PT-020」 (Please see above image indicated by an arrow)
- “Red” O-ring is uniformly compressed and firmly/properly seated in the O-ring groove.

When you rotate the 「28AD Port」 (arrow (2) in above image), make sure to rotate slowly and firmly with keeping no gap between contact surface between the 「28AD Port」 and 「PT-027」/「PT-020」. Otherwise 『Pawl』 of 「28AD Port」 could fail to grasp 『Boss』 of 「PT-027」/「PT-020」 and leads to damage to 「28AD Port」 and 「PT-027」/「PT-020」 and/or flooding

## (Preparation)

### • **Attaching Base Plate**

Attach the Base Plate on the bottom of the housing so that its plane surface facing you and channel part grasp housing arm base. Then push the Base Plate further into groove with screw holes of 28AD Port. **(3)** Slightly rotate the 28AD Port Unit not to displace the Base Plate to match screw holes of the 28AD Port Unit with screw holes of the Base Plate**(4)**. **Put two cap screws straight into the screw holes and partially tighten them with Allen Wrench (5). Make sure to put two cap screws straightforward, or the Base Plate could be damaged.**

Fasten the Base Plate to the housing by screwing 1/4 Tripod Screw into center screw hole of the Base Plate after confirming that the Base Plate and housing base is parallel, and tripod screw hole of the housing and the center screw hole of the Base Plate is aligned. **(6)**

Lastly tighten two cap screws completely to fasten the 28AD Port Unit with the Base Unit. **(7)**

**DO NOT tighten too much, or the Base Plate could be damaged.**

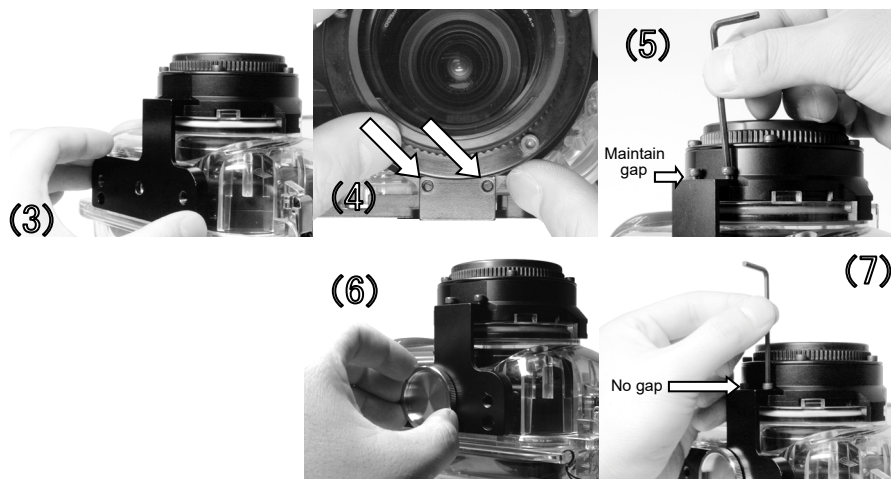

This product comes with a black plastic or metal 1/4 Tripod Screw depending on manufacturing lot (no difference on functionality). Also there are two types for metal 1/4 Tripod Screw. The 『current type』 metal screw is slightly different from other 『previous type』 metal screw shipped with old mount bases .

“ 『Current type』 plastic/metal screw is universal type and can be used for any AD Mount Bases while

“ 『previous type』 metal screw can not be used for recent model like AD Mount Base ・ PT-041, 28AD Mount Base ・ PT-043. **If you have different mount bases, please make sure to use original 1/4 tripod screw supplied with the mount base itself.** Using 『previous type』 for non-compatible mount base may cause damage on a housing.

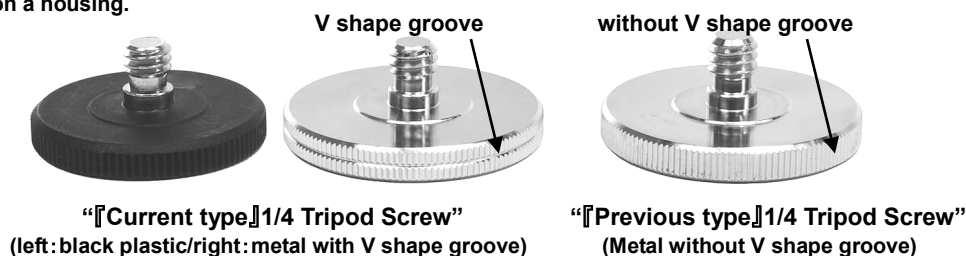

### • **Attaching Attachment Lens/Grip Base D4 / Optical D Cable Type L**

Please refer to each product user manual.

Depending on housing/camera or combination of attachment lens /28AD Port, built-in flash light could possibly get through from joint part of the attachment lens and expose in an image. We would recommend to use an External Strobe together with INON 『Optical D Cable』 which is compatible with 『Clear Photo System』 **without using built-in flash.**

## Pre-use check

- To make sure the assembly has been done properly and waterproof property, **immerse the assembled 28AD Port/housing in clean/fresh water(below 30℃ / 86°F) and confirm there is no flooding between the 28AD Port and the housing.**

- How to disassemble:**
- First remove the Base Plate then remove the 28AD Port Unit in reverse procedure of “how to attach”.
  - Attaching the Base Plate in opposite side as shown in right image makes it easy to unscrew the 28AD Port in direction of the arrow(8). **DO NOT apply pressure on the Base Plate other than direction to rotate to avoid damage on the 『Boss』 of the housing, 『Pawls』 of the 『28AD Port』.**



- Handling Precautions:**
- Refer to housing user manual for maintenance. **Apply Olympus genuine grease in the screw holes(for cap screws) of the Base Plate** by toothpick or something like that.
  - Please do not inquire housing manufacturer about installing this product or replacing black “O-ring” of the 28AD Port Unit with “Red” O-ring of 「PPO-01」. The housing manufacturer has no concern with the installation of this product or O-ring replacement. Also you have to take full responsibility regarding the installation of this product.
  - INON Inc. assume no responsibility whatsoever for any damages(damage to housing / housing accessory / camera) resulting from the use of this product.
  - Should you have trouble like flooding caused by the modification, INON Inc. can not take any responsibility for incidental damage(relevant expense to take a shot etc.)
  - Please perform the modification only if you can accept above conditions.

INON Inc.

2-18-9, Dai, Kamakura,  
Kanagawa 247-0061 JAPAN  
E-mail [support@inon.co.jp](mailto:support@inon.co.jp)  
Fax. +81(0)467-48-2178  
URL <http://www.inon.co.jp/>

May 2009