

INON

INON Optical D Cable Type L · Bush W58 Set

Thank you for purchasing INON product

INON Optical D Cable Type L · Bush Set connects INON strobe and compatible digital camera housing. Optical D Cable Type L · Bush W58 Set is exclusively for Canon 「WP-DC44」 / 「WP-DC46」 .

Features

- Reliable slave flashing of [Optical D Cable connection] with fiber optics under bright condition like under surface or back lit.
- Maximum two 「Optical D Cable Type L」 mountable for dual strobe configuration.

- Package contents :**
- Optical D Cable Type L ① ×1
 - Double Hole Rubber Bush for Fiber Optics ② ×1
 - Rubber Bush Base ③ ×1
 - Adhesive Sticker (spare) ④ ×1
 - Rubber Bush Base Sticker ⑤ (including one spare) ×1
 - This user manual ×1

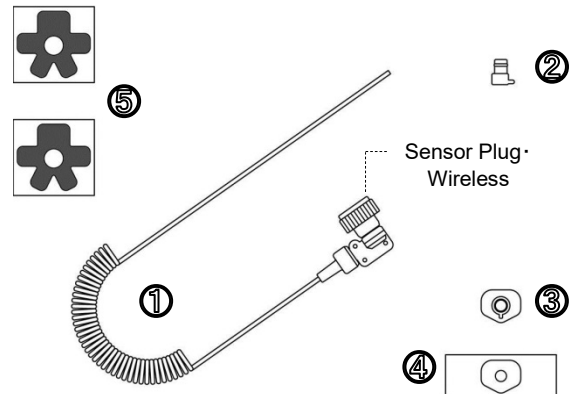

- Compatible housing:** (as of May 2018)
- Canon WP-DC44
 - Canon WP-DC46

- Compatible strobe :** (as of May 2018)
- **Wireless compatible strobes (Optical D Cable Type L is attached as it is)**
INON Z-330, S-2000, Z-240 【Type 4】 , D-2000 【Type 4】

- **Wireless non-compatible strobes (Sensor Plug has to be replaced with optional "Sensor Plug · Non-Wireless" (※))**

- INON Z-240 【Type 3/ Type 2/ Type 1】 , D-2000 【Type 3/ Type 2/ Type 1】 , D-2000W, D-2000Wn, D-2000S, D-180, D-180S, Z-220F, Z-220S, Z-220
- INON TTL Sensor Z + INON Z-22
- INON TTL Sensor SB + compatible TTL auto strobe
- INON TTL Sensor YS + compatible TTL auto strobe
- INON Focus Light Controller + INON Z-220F/Z-220S/Z-220/Z-22



*「Sensor Plug · Non-Wireless」
【Optional】*

(※) Refer to an instruction manual 「L-Connector Modification Instruction」 which comes with the optional 「Sensor Plug · Non-Wireless」 for detail of replacement

- How to attach :**
- **Attach 「Rubber Bush Base」 on housing**

Remove a sticker base from back of the 「Rubber Bush Base」 (a) and attach it on the compatible housing so that the center hole covers center of the raised built-in flash surface (b) and press it firmly against the housing wall (c). Leave it for a day or so to make it firmly attached further. Then remove a sticker base from the 「Rubber Bush Base Cover Sticker」 and attach on the 「Rubber Bush Base」 as shown in image (e).

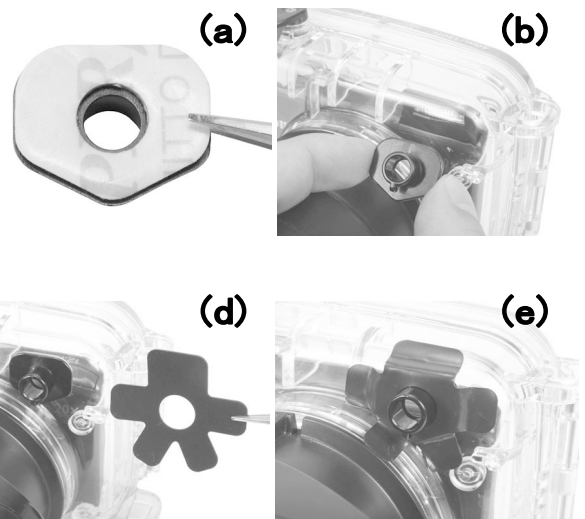

- **Attach Optical D Cable Type L**

Put 「Optical D Cable Type L」 into 「Double Hole Rubber Bush for Fiber Optics」 so that bare end of the cable is projected at about 0.5mm to securely transmit built-in flash light. Then put the 「Double Hole Rubber Bush for Fiber Optics」 in the 「Rubber Bush Base」 on the housing all the way. Either single or double cable configuration is supported by the 「Double Hole Rubber Bush for Fiber Optics」 .

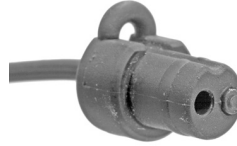

- Screw the “black plastic cap [strobe connector]” of the Optical D Cable Type L on strobe “slave sensor” (S-2000, Z-240, D-2000 series/D-180 series) / “TTL Slave Sensor (Z-220F, Z-220S, Z-220)”. Refer to respective strobe user manual for detail of installation method.
DO NOT tighten too much to avoid damage of the strobe connector or sensor of strobe.



Handling precaution:

- Optical D Cable Type L has ultra durability (minimum bend radius 2mm) but **inner portion could be damaged when bending less than radius of 2mm or excessive shock.** And **if the cable being bended for long time, it will not back to original shape.** Replace with optional 「Replacement Optical D Cable Type L/Optical Cable M Type L」 in case of poor signal transmission.
- When carrying your camera system, DO NOT hold the Optical D Cable Type L with being connected to a housing or a strobe to prevent the fiber optics coming off from the L- Connector or accidental damage on strobe/L-Connector/Optical Cable etc.
- Basically 「Rubber Bush Base」 and 「Rubber Bush Base Sticker」 are not reusable once they are removed. When you need to replace them or adhesive sticker lose adhesion, use supplied spare 「Adhesive Sticker」, 「Rubber Bush Base Sticker」 or optional 「Rubber Bush Base W58」 .
- Housing diffuser panel is not usable together with this product.

Maintenance

- Soak in fresh water (below 30°C/ 86°F) for several hours after use to dissolve any salt build up. Blow off water drop by air gun/blower and dry in shaded and well ventilated area. It may take several days to completely dry.
- Especially **take care to clean the “bear end” of the Optical D Cable Type L and other bear end in the “black plastic[L Connector]” to dissolve any salt build up. Scratch or cloud with salt build up on the bear edge may lead poor signal transmission.**
- In the event of poor signal transmission resulting from scratch/cloud or necessity to shorten the cable, it is possible to cut the cable to refresh the damaged edge or to get desired length. Refer to our web site below to cut strobe connector side.

“L Connector Modification Instruction”

http://www.inon.jp/pdf-dl/_userdata/ModifyCableConnector-en.pdf

When you cut the Optical D Cable Type L, use sharp blade like a razor or a utility knife and make sure to cut the edge flatly. If you observe roughness on the cable section, cut it again to prevent poor signal transmission.



Before installing this product

- Please note that housing manufacture has no concern with the installation of this product on the housing. Do not inquire housing manufacture about the installation. Also please note that you have to take full responsibility for the installation.
- Warranty of housing may be void by installing this product even though warranty has not been expired. Refer to housing user manual/warranty statement for detail.
- INON Inc. can not take any responsibility for any trouble/damage(damage to housing/housing accessories/camera) resulting from the installation.
- Should you have trouble like flooding caused by the installation, INON Inc. can not take any responsibility for incidental damage(relevant expense to take a shot etc.)
- **Please perform the installation only if you can accept above conditions. Otherwise do not make the installation.**

- Optional Parts** :
- Optical D Cable Type L
① in the product illustration in the first page. Necessary when connecting 2nd strobe.
 - Replacement Optical D Cable Type L/Optical Cable M Type L
① in the product illustration *without connector*
 - Rubber Bush Base W58
③, ④ and ⑤ in the product illustration.
 - Double Hole Rubber Bush for Fiber Optics
② in the product illustration.
 - L-Connector Kit (strobe) · Wireless
Replacement strobe connector unit without a cable. Same strobe connector as originally installed on this product.
 - Sensor Plug · Wireless
Replacement sensor plug unit originally installed on this product.
 - Sensor Plug · Non-Wireless
Replacement Sensor Plug unit to be replaced with originally installed Sensor Plug to use for Non-Wireless strobes described on th

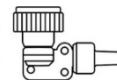

INON Inc.

2-18-9, Dai, Kamakura,
Kanagawa 247-0061 JAPAN

E-mail support@inon.co.jp

Fax. +81(0)467-48-2178

URL <http://www.inon.jp/>

May 2018