

INON

INON LD Lens Holder DP-S / LD Lens Holder DP for Float Arm

Thank you for purchasing INON product.

INON LD Lens Holder DP is attached on compatible strobe arm/Grip Base to carry 28LD Mount series attachment lens to help easy and speedy lens replacement underwater.

Features

- INON 28LD Mount (bayonet mount) compatible. Carries INON 28LD Mount series lens on compatible Arm body / YS Arm body / Float Arm body / Grip Base.
- LD Lens Holder DP series can carry "UFL-M150 ZM80" and "UWL-S100 ZM80" as well as 28LD Mount series lenses.

- Package contents :**
- LD Lens Holder [screw] ① ×1 (DP-S* only)
 - LD Lens Holder [hole] ② ×1 (DP-F* only)
 - Lens Holder Base ③ ×1 (DP-S * only)
 - Thumb Knob Screw ④ ×1 (DP-S * only)
 - Allen Wrench ⑤ ×1 (DP-F * only)
 - This user manual ×1

**DP-S" stands for "LD Lens Holder DP-S",
and "DP-F" for "LD Lens Holder DP for Float Arm"



- Compatible lens/ accessory (as of February 2015)**
- INON 「UFL-M150 ZM80」 Underwater Micro Fisheye Lens + 「M27-LD Mount Converter for UFL-M150 ZM80」
 - INON 「UWL-S100 ZM80」 Wide Conversion Lens + 「M52-LD Mount Converter for UWL-S100 ZM80」
 - INON 「UWL-H100 28LD」 Wide Conversion Lens
 - INON 「UCL-165LD」 「UCL-100LD」 Close-up Lens
 - INON 「AD-LD Mount Converter for UCL-165AD」
 - INON 「M67-LD Mount Converter for UCL-330/165M67」

- Compatible arm (as of February 2015)** : LD Lens Holder DP type differs among different strobe arm/Grip Base etc. to use.
Please check if your LD Lens Holder DP is compatible with your strobe arm/Grip Base etc. before installation.

● LD Lens Holder DP-S compatible products

- INON Grip Base DII with Rubber Grip D, Grip Base DIII with Rubber Grip D
- INON D Holder Extension Bar + Grip Base D4/Grip Base M1/D Holder
- INON Arm body(SS/S/M/L), YS Arm body(MS/M)

● LD Lens Holder DP for Float Arm compatible products

- INON Float Arm body(S/M/ML), Mega Float Arm body(S/M)
- INON M5 Joint + Stick Arm body(SS/S/M/L)
- INON M5 Joint + Multi Arm body(ML/L/LL/XL)

● Compatible products to be sandwiched between LD Lens Holder DP [screw] and LD Lens Holder DP [hole]

- INON Arm body(SS/S/M/L) , YS Arm body(MS/M)

Any of compatible arm can be sandwiched between LD Lens Holder DP [screw] and LD Lens Holder DP [hole]. (It is also possible to mix with INON LD Lens Holder series.)
To assemble this combination, **optional Cap Screw packaged with "LD Lens Holder W"** is required.

How to install : ① Attach 「LD Lens Holder DP-S」 on Grip Base DII/DIII, Arm Body, YS Arm Body

Attach the LD Lens Holder [screw] and the Lens Holder Base on compatible arm as shown in images below so that the arm seats in groove between the lens holder and the base. *INON logo on the Lens Holder Base must face you (center image). Then fix them by the Thumb Knob Screw (right image).



(How to install) : ② Attach 『LD Lens Holder DP-S』 on 『D Holder Extension Bar』 + compatible products

Refer to 『D Holder Extension Bar』 user manual for detail of installation and usage.

③ Attach 『LD Lens Holder DP for Float Arm』 on Float Arm Body or Mega Float Arm Body

Attach the LD Lens Holder [hole] on compatible product as shown in **image [left]** below so that the Lens Holder base on the compatible product seats in groove of the LD Lens Holder [hole]. Then fix it by the Cap Screw supplied with compatible product (center image).

DO NOT use any other cap screw comes with other products or compatible products will be damaged.
DO NOT tighten too much to avoid accidental damage on the LD Lens Holder.



Maximum two LD Lens Holder [hole] can be attached on Float Arm/Mega Float Arm as they have Lens Holder bases on both sides.

④ Attach 『LD Lens Holder DP for Float Arm』 on 『M5 Joint』 + compatible products

Refer to 『M5 Joint』 user manual for detail of installation and usage.

⑤ Attach LD Lens Holder [screw] and LD Lens Holder [hole] on Arm Body, YS Arm Body

Attach the LD Lens Holder [screw] and the LD Lens Holder [hole] on compatible arm as shown in images below so that the arm seats in groove between the two parts. *LD Lens Holder [hole] must face you. Then fix them with the Cap Screw (cap screw supplied with the LD Lens Holder W) by using supplied Allen Wrench. **DO NOT tighten too much to avoid damage on the LD Lens Holder.**

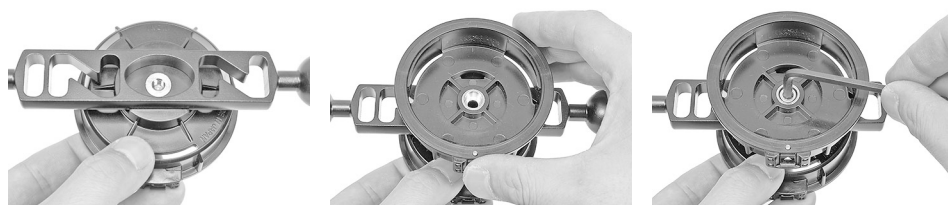

How to attach compatible lens : Follow same procedure to attach on 28LD Mount Base. Refer to 28LD Mount series lens user manual for detail.

**Maximum mountable number of this unit per compatible product :
(as of February 2015)**

Combined product	One side	Both sides mount compatibility	Total
Grip Base D II / Grip Base DIII	1	No	1
Grip Base D4(*1)	1	No	1
Grip Base M1(*1)	1	No	1
D Holder(*1)	1	No	1
Arm SS/S Body	1	Yes	2
Arm M Body	2	Yes	4
Arm L Body	3	Yes	6
YS Arm MS Body	1	Yes	2
YS Arm M Body	2	Yes	4

Combined product	One side	Both sides mount compatibility	Total
Float Arm S/M/ML Body	1	Yes	2
Mega Float Arm S/M Body	1	Yes	2
Stick Arm SS/S/M Body (*2)	1	No	1
Stick Arm L Body (*2)	3	No	3
Multi Ball Arm ML/L Body (*2)	1	No	1
Multi Ball Arm LL/XL Body (*2)	3	No	3

(*1) When used in combination with 『D Holder Extension Bar』

(*2) When used in combination with 『M5 Joint』

INON Inc. 2-18-9, Dai, Kamakura, Kanagawa 247-0061
 E-mail support@inon.co.jp / Fax. +81(0)467-48-2178
 URL <http://www.inon.jp/>

February, 2015