

# INON

## INON Optical D Cable Type L · Rubber Bush Set 2

Thank you for purchasing INON product.

INON **Optical D Cable Type L · Rubber Bush Set 2** transmits compatible camera's built-in flash light via multi-core fiber optics to trigger an external strobe. The connector on the housing side is standard configuration with **Single Hole Rubber Bush Type L**. By replacing it with the supplied **Double Rubber Bush Type L Body**, maximum two "**Optical D Cable Type L**" can be fixed.

 **Make sure to rinse bear ends of the cable right after diving and dry completely to prevent fogging of the bear ends to ensure reliable strobe triggering.**

- Package contents:**
- Optical D Cable Type L ① ×1
  - Single Hole Rubber Bush Type L ② ×1  
(Preinstalled on the Optical D Cable Type L)
  - M2 Cap Screw ⑤ ×2
  - Rubber Bush Type L Case ⑥ ×1
  - Single Hole Rubber Bush Type L Body ⑦ ×1
  - Rubber Bush Type L Case (screw) ⑧ ×1
  - Double Hole Rubber Bush Type L Body ③ ×1
  - M2 Allen Wrench (WAF: 1.5 mm) ④ ×1
  - This user manual ×1

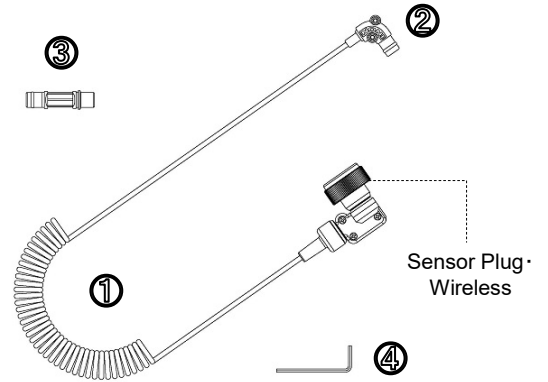

**Compatible :  
camera system**

- A housing equipped with an "optical cable adapter" having approximately 7 mm/0.3 in. diameter cable inlet.

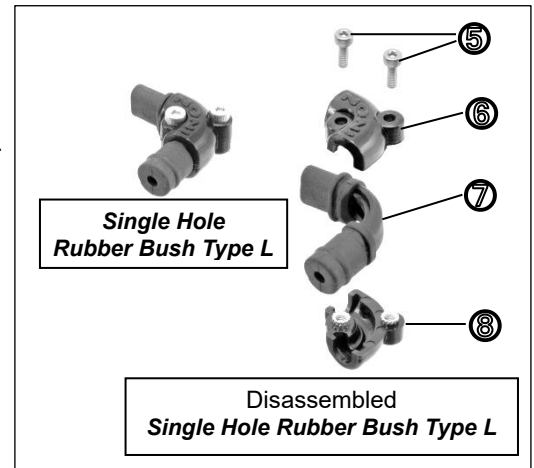

**Compatible strobe:  
(as of March 2021)**

- **Wireless compatible strobes (Optical D Cable Type L is attached as it is)**  
INON Z-330, D-200, S-2000, Z-240 Type 4, D-2000 Type 4
- **Wireless non-compatible strobes (Sensor Plug has to be replaced with optional "Sensor Plug · Non-Wireless" \*)**  
INON Z-240 Type 3/Type 2/Type 1, D-2000 Type 3/Type 2/Type 1,  
D-2000W, D-2000Wn, D-2000S, D-180, D-180S, Z-220F, Z-220, Z-220S
- INON TTL Sensor Z + INON Z-22
- INON TTL Sensor SB + compatible TTL auto strobe
- INON TTL Sensor YS + compatible TTL auto strobe
- INON Focus Light Controller + INON Z-220F/Z-220S/Z-220/Z-22



**Sensor Plug · Non-Wireless  
[Optional]**

\* Refer to an instruction manual "L-Connector Modification Instruction" which comes with the optional "Sensor Plug · Non-Wireless" for detail of replacement

**How to use :**

- **Install an optical cable adapter (supplied with a housing) on a housing**  
If your housing comes with an optical cable adapter/retainer to connect an optical cable on your housing, attach it on the housing. Refer to housing user manual for detail of installation etc.
- Next attach the **Rubber Bush Type L** to the fiber optics hole/inlet. Make sure to put it in all the way to prevent it from accidental separation.



**How to add extra  
Optical D Cable Type L**

- Replacing the preinstalled **Single Hole Rubber Bush Type L Body** with the bundled **Double Hole Rubber Bush Type L Body** enables to hold maximum two "Optical D Cable Type L".

**Replacement procedure**

- (A) First, disassemble the preinstalled **Single Hole Rubber Bush Type L**②. Remove two **M2 Cap Screw**⑤ by **M2 Allen Wrench**④ and separate **Single Hole Rubber Bush Type L Body**⑦\* from **Rubber Bush Type L Case**⑥/**Rubber Bush Type L Case (screw)**⑧.
- (B) Pull out the cable from **Single Hole Rubber Bush Type L Body**⑦.
- (C) Insert\*\* bear ends of the removed cable and the extra cable into the **Double Hole Rubber Bush Type L Body**③.

\* Keep the removed **Single Hole Rubber Bush Type L Body** for future use.

\*\* Make sure to insert the bear end all the way so that there is no gap between the bear end surface of the cable and surface of the other end of the **Rubber Bush Type L**. If the bear end of the cable has not been properly set, it may cause inaccurate exposure by an external strobe or even failing to fire the strobe.

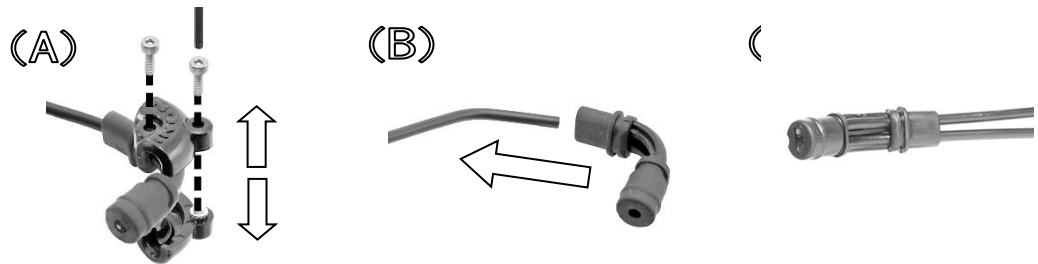

- (D) Reassemble the **Rubber Bush Type L** by following reverse procedure to disassembling it. Sandwich **Rubber Bush Type L Body**⑦ between **Rubber Bush Type L Case**⑥ and **Rubber Bush Type L Case (screw)**⑧ so that the rubber bush seats in the case completely as per below image (D).

- (E) Then interlock two cases with 2 x **M2 Cap Screw**⑤ by supplied **M2 Allen Wrench**④.

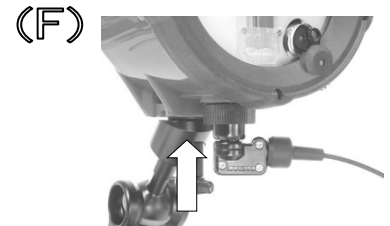

- (F) Screw the "black plastic cap [sensor plug]" of the **Optical D Cable Type L** on strobe "slave sensor" (Z-330, D-200, S-2000, Z-240, D-2000 series/D-180 series)/"TTL Slave Sensor (Z-220F, Z-220S, Z-220) or "TTL Sensor"/"Focus Light Controller". Refer to respective strobe/TTL Sensor/Focus Light Controller user manual for detail of installation method. DO NOT tighten too much to avoid damage of the strobe connector or sensor of strobe/TTL Sensor/Focus Light Controller.

**Maintenance**

- After using, remove from camera system/strobe and soak in fresh water (below 30°C/86°F) for several hours after use to dissolve any salt build up. Blow off water by compressed air and dry in shaded and well ventilated area. It may take several days to completely dry.
- Especially take care to clean the both edge of the Optical D Cable Type L to dissolve any salt build up. Scratch or cloud with salt build up on the edge may lead poor signal transmission.

- In the event of poor signal transmission resulting from scratch/cloud or necessity to shorten the cable, it is possible to cut the cable to refresh the damaged edge or to get desired length. Refer to relevant information on our web site when cutting strobe connector side.

**"L Connector Modification Instruction"**

<http://www.inon.jp/pdf-dl/userdata/ModifyCableConnector-en.pdf>.

When you cut the **Optical D Cable Type L**, use sharp blade like a razor or a utility knife and make sure to cut the edge flatly. If you observe roughness on the cable section, cut it again to prevent poor signal transmission.

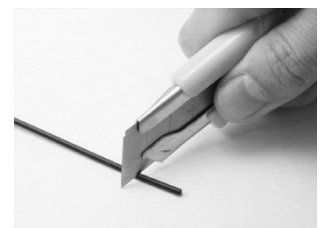

- Handling precaution:**
- **Optical D Cable Type L** has ultra durability (minimum bend radius 2 mm) but *inner portion could be damaged when bending less than radius of 2 mm or applying excessive shock. And if the cable being bended for long time, it will not back to the original shape.* Replace with optional **Replacement Optical D Cable Type L/Optical Cable M Type L** in case of poor signal transmission *not* caused by scratch/cloud.
  - When carrying your camera system, **DO NOT** hold the **Optical D Cable Type L** with being connected to a housing or a strobe to prevent the fiber optics coming off from the **L- Connector** or accidental damage on strobe/L-Connector/Optical Cable etc.

**Optional Parts:**

- Replacement Optical D Cable Type L/Optical Cable M Type L  
① in the product illustration without connector and **Single Hole Rubber Bush Type L**

- Single Hole Rubber Bush Type L  
Set of ② in the product illustration without the cable, and ④.



- Double Hole Rubber Bush Type L  
Set of ③⑤⑥⑧ and ④ in the product illustration.



- Double Hole Rubber Bush for Fiber Optics  
A rubber bush designed to attach to a fiber optics adapter of a housing to hold maximum two optical cables.



- L-Connector Kit (strobe) - Wireless  
Replacement strobe connector unit without a cable and **Rubber Bush Type L**. Same strobe connector as originally installed on this product. Usable for “wireless” strobe described on the first page of this manual.

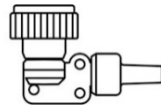

- Sensor Plug - Wireless  
Replacement **Sensor Plug** unit originally installed on this product.



- Sensor Plug - Non-Wireless  
Replacement **Sensor Plug** unit to be replaced with originally installed **Sensor Plug** to use for “Non-Wireless” strobes described on the first page of this manual.



INON Inc.

2-18-9, Dai, Kamakura,  
Kanagawa 247-0061 JAPAN

E-mail [support@inon.co.jp](mailto:support@inon.co.jp)

Fax. +81(0)467-48-2178

URL <http://www.inon.jp/>

March 2021